

4110294786



Nearest Intersection: Wilson Rd and Yarrow Central Rd.
Distance from lot to intersection is 147 meters (82 degrees East of South).
View Scale: 1:1000

42525 Yarrow Central Rd, Chilliwack

Order #: 30991600 Prem #: 282080 City Limits: Chilliwack

X: 1288918195.00 Y: 459846836.00

2018/03/22

ATTENTION: DO NOT RELY ON THIS INFORMATION ALONE. You must manually dig to locate gas lines before using excavation machinery. All locations are shown approximate only & gas lines that differ the date below are not in this information package. ForB/C will not accept responsibility for errors or omissions. Depth of gas line are not available due to possible change of grade.

42525
 42525 Yarrow Central Rd. Vernon B.C. May 1, 19
 SERVICE ADDRESS: 42525 Yarrow Central Rd. 18' ONT. DATE COMPLETED: May 1, 19
 MAIN ON: 42525 Yarrow Central Rd. 18' ONT. DATE COMPLETED: May 1, 19
 SERVICE ADDRESS: 42525 Yarrow Central Rd. 18' ONT. DATE COMPLETED: May 1, 19
 MAIN ON: 42525 Yarrow Central Rd. 18' ONT. DATE COMPLETED: May 1, 19
 SERVICE ADDRESS: 42525 Yarrow Central Rd. 18' ONT. DATE COMPLETED: May 1, 19
 MAIN ON: 42525 Yarrow Central Rd. 18' ONT. DATE COMPLETED: May 1, 19

LABOR	HRS.	REMARKS:
FITTER/S. P/MAN	2 1/2	TESTED - O.K.
HELPER/M.S. MAN	2 1/2	
LABORER	1 1/2	
SUPERVISOR		J. HARRIS

SERVICE PLAN: RECORD ANY ADDITIONAL MEASUREMENTS WITH REFERENCE TO POLES IN STREET, CUSTOMER'S ADJACENT PROPERTY, OR ANY OTHER PIPES AND PERMANENT OBJECTS. SHOW FOOTAGE DOWN SIDE OF BUILDING. SHOW LOCATION OF ANY DRIP OR JOG IN SERVICE. USE LARGE CENTRE BLOCK FOR DIAGRAM OF SERVICE TO CUSTOMER'S PREMISES.

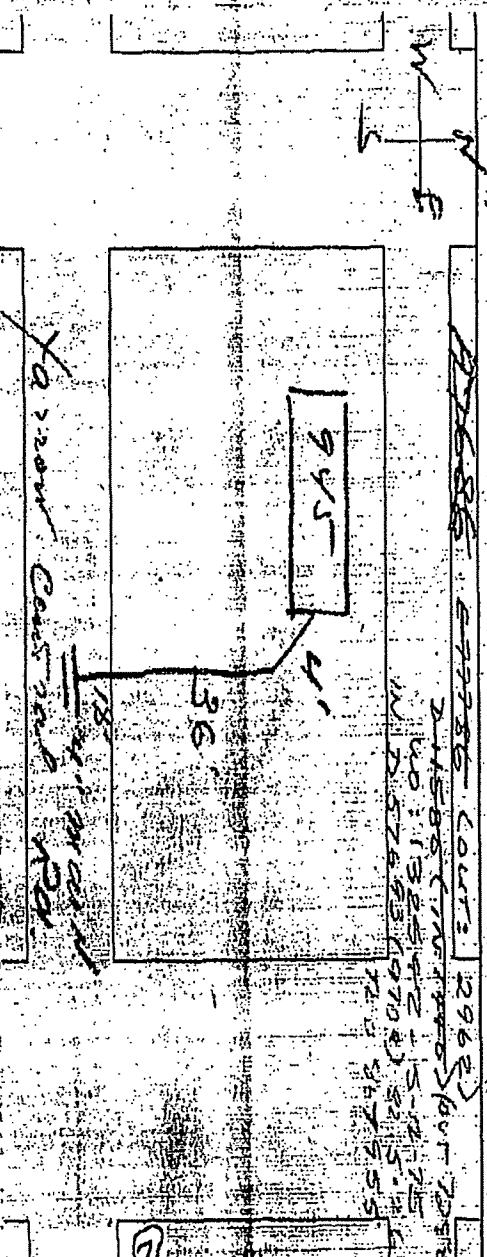

42525 YARROW CENTRAL ROAD CHILLIWACK 3/22/2018 12:25:13 PM

FORTIS BC GAS
 GAS SERVICE INSTALLATION
 42525 YARROW CENTRAL

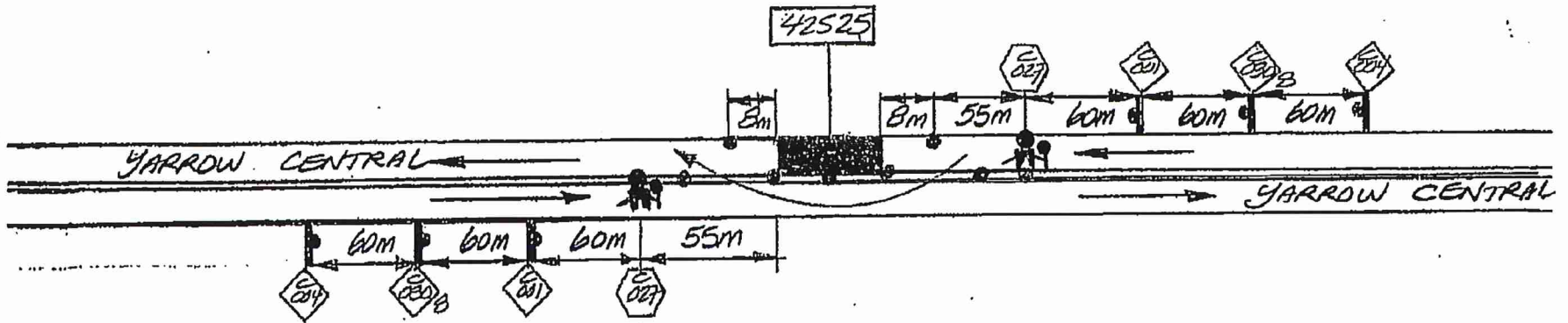

NOTES: FIG 3.4.1, MANUAL
 LANE CLOSURE WITH TCPS
 TWO LANE - TWO WAY
 ROADWAY.

FORTIS # 30991600 APR. 14/18